

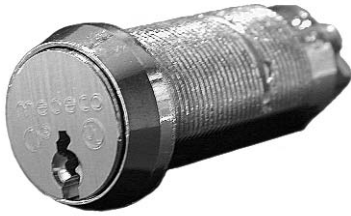

High Security Switch Locks



Medeco's 3/4" diameter UL listed switch lock offers a wide range of electrical functions combined with the security and key control of a Medeco cylinder. This unique combination is ideally suited for applications requiring controlled access to electrically activated systems.

These locks are available in a single switch and double switch. Both styles feature subminiature snap action switches for reliability and versatility. Switches are UL and CSA listed. Mechanical switch life is 1 million cycles and full load electrical life is 50,000 cycles minimum. Silver contact are standard, gold contact are available for low amperage applications.

LSI Part No.	"A"	No. of Pins	Material	Type
ME-6510	1.677"	5	Brass	Single Switch
ME-6525	1.677"	5	Brass	Double Switch

Switch Available in either silver or gold contacts

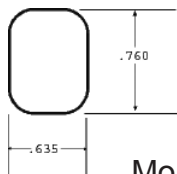
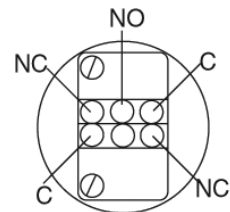
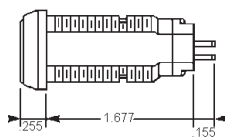
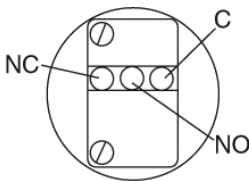

Mounting Hole

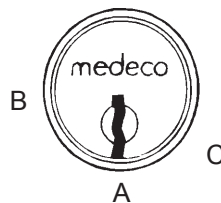

Function

1. Key pull at "A" only
2. Key pull at "A" and "B"
3. Maintained Contact (SPDT)
4. Maintained Contact (DPDT)
5. Momentary Contact (SPDT)
6. Momentary Contact (DPDT)

6025 Cinderlane Parkway - Orlando Florida 32810

407-298-9895 - 800-657-LOCK (5625) - Fax: 800-895-0706 - sales@lockingsystems.com - www.lockingsystems.com